

FIELD WELDED CLOSURE

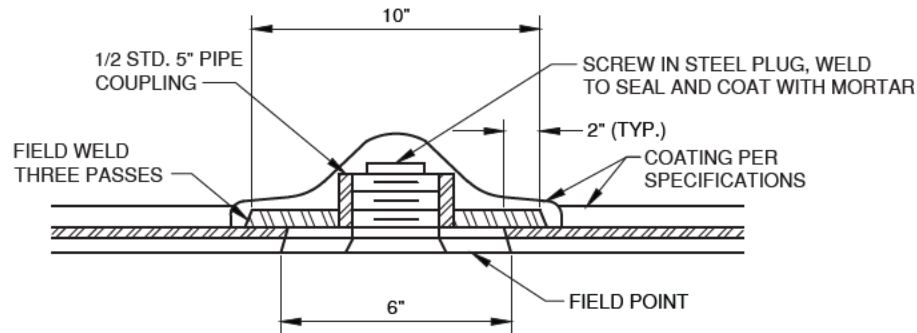

SECTION A-A
ENLARGED VIEW

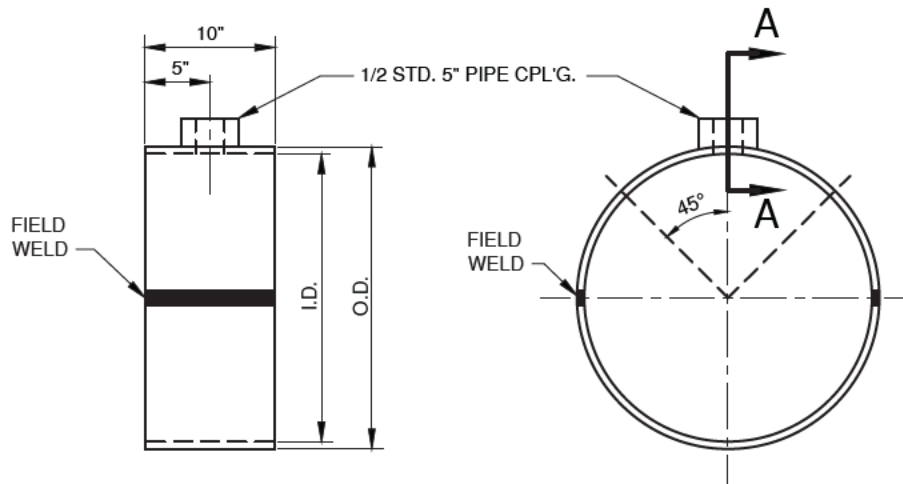

NOTES:

1. STRAP TO BE SHIPPED IN HALVES AND WELDED IN THE FIELD.
2. PLATE THICKNESS SHALL BE EQUAL TO ADJOINING STEEL PIPE EXCEPT THAT MINIMUM THICKNESS SHALL BE 3/16". WHEN PIPE I.D. EXCEEDS 14", PROVIDE TWO HANDHOLES AT 45° FROM VERTICAL.
3. TWO HANDHOLES FOR PIPE ≥ 16" DIAMETER.
4. WHERE ACCESS TO THE PIPE INTERIOR FOR MORTAR LINING IS NOT POSSIBLE, INSTALL 5" DIAMETER HANDHOLES WITH THREADED PLUG WHICH IS TO BE SEAL WELDED UPON COMPLETION OF FIELD MORTAR LINING. AT LEAST TWO HANDHOLES WILL BE REQUIRED FOR 18" DIAMETER AND LARGER PIPE.

APPROVED:

Wally P. [Signature] 5/16/19

District Engineer

Date

5/16/2019

Latest Revision Date



VALLEY CENTER MUNICIPAL WATER DISTRICT
STANDARD DRAWING

NOT TO SCALE

DWG. NUMBER

BUTT STRAP CLOSURE

W-19